



Price List

CREST
Manufacturing Corporation



Price List valid August 2008

CREST MANUFACTURING CORPORATION

GENERAL SPECIFICATIONS FOR LAMINATE PRODUCT

WARRANTY- The manufacturer shall guarantee casework, materials, and workmanship for **TEN YEARS** from the date of delivery. Defects reported within the guarantee period shall be corrected without charge. See written warranty for details.

A. Construction Features

- (1) All structural components shall be 45 lb./cu. ft. industrial grade and meet or exceed the American National Standard for Mat-Formed Wood Particleboard, ANSI A208.1, Grade 1-M-2. All surfaces shall be covered with laminate and all edges are to receive edgebanding. Uncovered particleboard surfaces are not acceptable.
- (2) All desks and table tops shall be 1 1/8" thick particleboard surfaced with decorative laminate.
- (3) All desk and table tops shall be edged with 2 mm PVC edgebanding. "Self-edge" edges are acceptable if 2 mm color not available. Self edged product carries a limited **FIVE YEAR** warranty.
- (4) All door/drawer fronts and pedestal box components shall utilize laminate bonded to both sides of a 3/4" core.
- (5) Permanent interior components such as fixed shelves, dividers and cubicle compartments shall be a full 3/4" thick particleboard with laminate on both sides.
- (6) All modesty panels shall be 3/4" thick particleboard surfaced with laminate on both sides.
- (7) All **BOOKCASES** have 1 1/8" thick components, with the exception of the back panel. All adjustable shelves within a bookcase are 1 1/8" thick and edged with PVC edge banding.
- (8) **Drawer Construction**
 - (a) Sides, back, sub-front shall be 1/2" thick black vinyl covered particleboard. Bottom to be 1/8" black hardboard, inserted into side grooves and hot melt glue to seal and strengthen drawer. File drawers have 2 stringers underneath for added strength.
 - (b) The drawer fronts shall be removable and attached to the drawer box with screws from inside the drawer.

B. Hardware

- (1) Hinges shall be fully concealed self-closing, 110 degree swing (European style).
- (2) Drawer Slides shall be epoxy coated bottom mount with captive roller design and 100 pound dynamic load test rating. Full extension slides shall be available at an additional charge.
- (3) Adjustable Shelf Supports shall be metal, nickel plated, and mounted in a row hole system on 32 mm centers.
- (4) Locks - for full height and three quarter pedestals are to "Timberline" with numbered keys and to be with removable cores.
- (5) Levelers- All floor furniture is to receive a 5/16" threaded base leveler bolt and plastic glide. It shall be fastened into a metal insert nut mounted into the particleboard.
- (6) Hanging File Folder Frames- file drawers receive a metal hanging-file extrusion that mounts to the top of the drawer box. It shall allow free and easy movement of the files' arms over its surface. Also included is a 16 gauge metal bracket that receives a 1/8" thick metal bar, spanning the width of the drawer that allows the drawer to accommodate folders in a lateral fashion.



CREST MANUFACTURING CORPORATION

1000 SERIES WORKSTATIONS

LIST PRICE

Conference Workstation

1PU2466 (36" P Top)	\$ 1,638.00
1PU2472 (36" P Top)	\$ 1,680.00
1PU3066 (42" P Top)	\$ 1,743.00
1PU3072 (42" P Top)	\$ 1,785.00

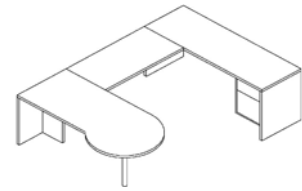

1BU3066	\$ 1,656.00
1BU3072	\$ 1,692.00

#PL-27- 36" Dia. Top- POST LEG	\$ 81.00
#TL-30- 42" Dia. Top- T-LEG	\$ 114.00
Full Laminate Modesty w/T-Panel	\$ 357.00
P-Top Mod. (24/30"D x 78/84"W)	\$ 84.00
Worksurface Depth (36"D)	\$ 216.00

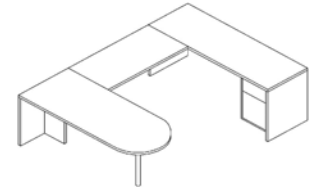

"U" Shaped Desk

1U3066	\$ 1,737.00
1U3072	\$ 1,803.00
1U3672	\$ 1,875.00

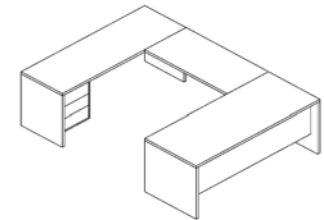

Worksurface Mod. (24/30"D x 78/84"W)	\$ 78.00
Worksurface Mod. (36"D x 78/84"W)	\$ 108.00

"L" Shaped Desk (48" Return)

1PL2466 (36" P Top)	\$ 1,077.00
1PL2472 (36" P Top)	\$ 1,104.00
1PL3066 (42" P Top)	\$ 1,179.00
1PL3072 (42" P Top)	\$ 1,197.00

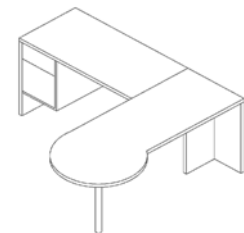

1BL3066	\$ 1,077.00
1BL3072	\$ 1,104.00

1L3060	\$ 1,140.00
1L3066	\$ 1,212.00
1L3072	\$ 1,233.00
1L3672	\$ 1,344.00

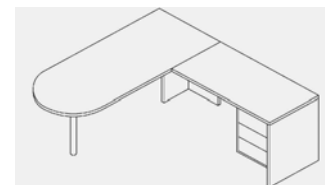

Optional 60" Return	\$ 69.00
1/2 Leg Support (w/ mounting plate)	\$ 114.00
Full Pedestal (File/File OR Box/Box/File)	\$ 177.00
Full Modesty Panel ≤ 60"	\$ 177.00
Full Modesty Panel > 60"	\$ 225.00
Flush Modesty Panel	N/C
Standard 3/4 Pedestal Deduct	\$ (195.00)

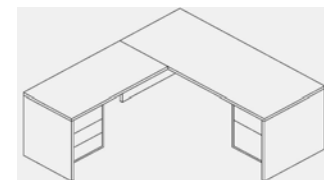

CREST MANUFACTURING CORPORATION

DESKS AND CREDENZAS

LIST PRICE

Double Pedestal Desk

1DP2460D	\$	876.00
1DP2466D	\$	894.00
1DP2472D	\$	918.00
1DP3060D	\$	936.00
1DP3066D	\$	957.00
1DP3072D	\$	981.00
1DP3660D	\$	975.00
1DP3666D	\$	1,014.00
1DP3672D	\$	1,038.00
Bow Front Top	\$	90.00

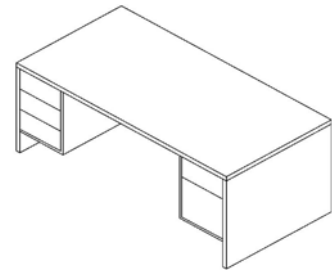

Shown w/ Standard Drawer Configuration:
Left Pedestal- Box/Box/Box
Right Pedestal- Box/File
Specify All Other Configurations

Single Pedestal Desk

1SP2448D	\$	504.00
1SP2460D	\$	594.00
1SP2466D	\$	612.00
1SP2472D	\$	639.00
1SP3048D	\$	600.00
1SP3060D	\$	675.00
1SP3066D	\$	705.00
1SP3072D	\$	732.00
1SP3660D	\$	729.00
1SP3666D	\$	756.00
1SP3672D	\$	789.00

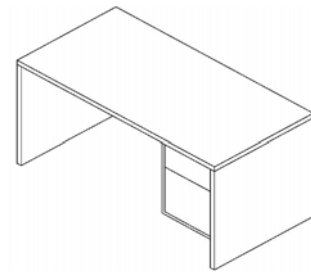

Shown w/ Standard Drawer Configuration:
Right Pedestal- Box/File
Specify All Other Configurations

Credenzas: Storage w/ Hinged or Sliding Doors

1SC2060D	\$	1,008.00
1SC2066D	\$	1,026.00
1SC2072D	\$	1,056.00
1SC2460D	\$	1,026.00
1SC2466D	\$	1,047.00
1SC2472D	\$	1,062.00

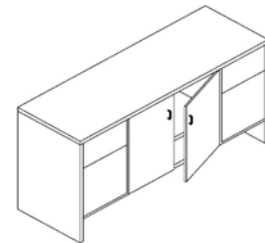

Credenza: Kneespace

1DC2060D	\$	858.00
1DC2066D	\$	876.00
1DC2072D	\$	900.00
1DC2460D	\$	876.00
1DC2466D	\$	891.00
1DC2472D	\$	909.00

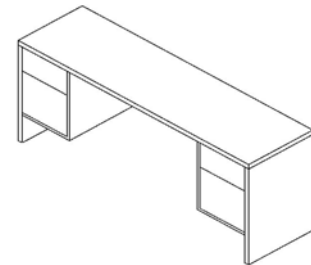

CREST MANUFACTURING CORPORATION

HUTCHES & BOOKCASES

LIST PRICE

Desktop Hutch- Gallery Edge

1H124836GT	\$	591.00
1H126036GT	\$	609.00
1H126636GT	\$	657.00
1H127236GT	\$	696.00
1H127836GT	\$	825.00
1H128436GT	\$	900.00
1H129036GT	\$	909.00
1H129636GT	\$	1,005.00
1H1210236GT	\$	1,293.00
1H1210836GT	\$	1,338.00
1H124842GT	\$	654.00
1H126042GT	\$	711.00
1H126642GT	\$	747.00
1H127242GT	\$	789.00
1H127842GT	\$	900.00
1H128442GT	\$	933.00
1H129042GT	\$	981.00
1H129642GT	\$	1,020.00
1H1210242GT	\$	1,293.00
1H1210842GT	\$	1,338.00
1H126048GT	\$	729.00
1H126648GT	\$	774.00
1H127248GT	\$	822.00
1H128448GT	\$	867.00
1H129648GT	\$	897.00
1H1210248GT	\$	1,383.00

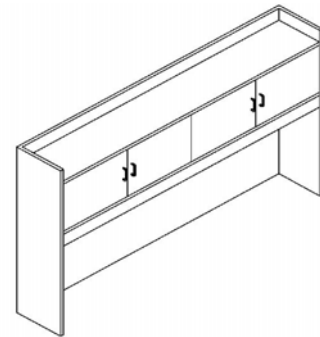
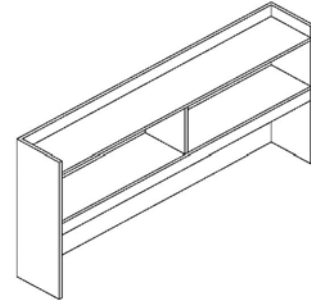

Show with Optional Hinged Doors:
 2 Pairs Needed- 72" & below
 3 Pairs Needed- 78" & above

Desktop Hutch- Flat Top

1H124836FT	\$	453.00
1H126036FT	\$	480.00
1H126636FT	\$	504.00
1H127236FT	\$	528.00
1H127836FT	\$	558.00
1H128436FT	\$	582.00
1H129636FT	\$	606.00
1H124848FT	\$	645.00
1H126048FT	\$	678.00
1H126648FT	\$	729.00
1H127248FT	\$	780.00
1H127848FT	\$	831.00
1H128448FT	\$	885.00
1H129648FT	\$	933.00

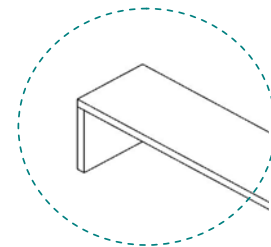

Flat Top Hutch Edge Detail

CREST MANUFACTURING CORPORATION

Desktop Hutch- Options

Hinged Door- 2 Pair/Hutch (up to 72")	\$	459.00
Hinged Door-3 Pair/Hutch (78" and up)	\$	684.00
Basic Task Light (18")	\$	58.00
Upgraded Task Light (24")	\$	120.00
Upgraded Task Light (48")	\$	150.00
w/ Lock (per pair of hinged doors)	\$	54.00
Finished Back	\$	132.00

Bookcase- 1 1/8" Shelves

1BC36301	\$	399.00
1BC36361	\$	438.00
1BC36422	\$	456.00
1BC36482	\$	480.00
1BC36603	\$	555.00
1BC36724	\$	618.00
1BC36845	\$	696.00
Finished Back	\$	132.00

Size	# Adj. Shelves	# Total Shelves
30"H	1	2
36"H	1	2
42"H	2	3
48"H	2	3
60"H	2	4*
72"H	3	5*
82"H	4	6*

* Fixed Shelf at 12" H

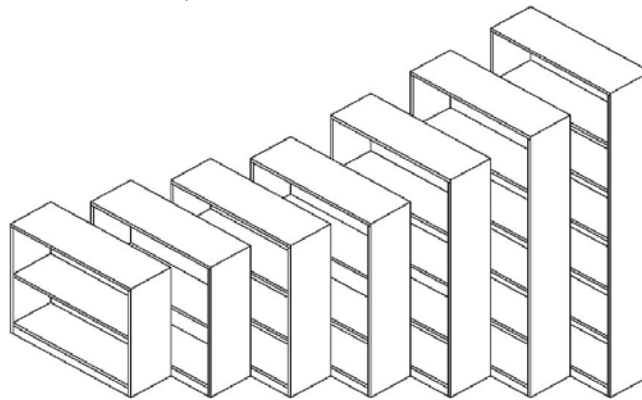

Bookcase Hutch

1BH3042	\$	375.00
1BH3642	\$	414.00
1BH4242 (center support)	\$	474.00
1BH3048	\$	417.00
1BH3648	\$	450.00
1BH4248 (center support)	\$	507.00

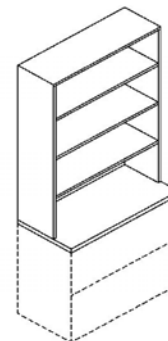

Bookcase Hutch Shown with Optional Lateral File Top (p. 8)

CREST MANUFACTURING CORPORATION

1000 SERIES TABLES

LIST PRICE

Mobile Typewriter Stand (27" Height)

1MS1832T	\$	381.00
1MS1836T	\$	405.00
1MS2040T	\$	423.00

Work Table (36" Counter Height)

1WT2460	\$	651.00
1WT2472	\$	678.00
1WT3060	\$	714.00
1WT3072	\$	744.00
1WT3672	\$	885.00

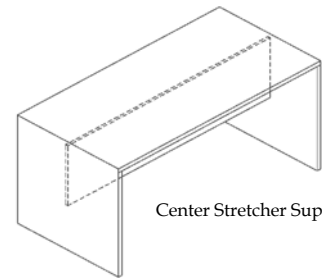

TV Production Table

1TVP2448	\$	744.00
1TVP2460	\$	792.00
1TVP2472	\$	834.00
1TVP3048	\$	858.00
1TVP3060	\$	885.00
1TVP3072	\$	912.00

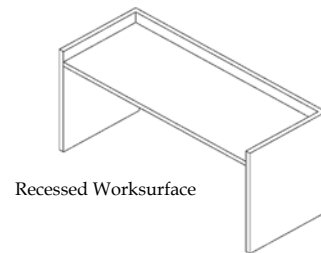

Computer/Data Table (Standard 29"H)

1DT2436	\$	348.00
1DT2442	\$	372.00
1DT2448	\$	399.00
1DT2460	\$	447.00
1DT2466	\$	480.00
1DT2472	\$	498.00
1DT3036	\$	477.00
1DT3042	\$	495.00
1DT3048	\$	513.00
1DT3060	\$	534.00
1DT3066	\$	558.00
1DT3072	\$	573.00
1DT3078	\$	630.00
1DT3084	\$	651.00

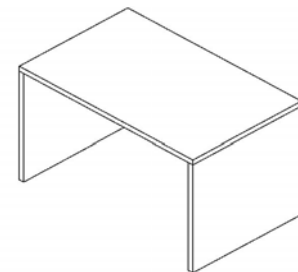

Specify "T" at end of Model No. for 27" H

Optional Components

Articulating Keyboard/Mouse Tray	\$	195.00
Deluxe Keyboard Tray w/ Mouse Pad	\$	300.00
Basic Power Strip (6')	\$	30.00
Wire Grommet	\$	30.00
Supply Tray (for box drawer)	\$	12.00
J-Wire Manager (cost per linear foot)	\$	8.20

Ergonomically Designed Components

CREST MANUFACTURING CORPORATION

Conference Tables

1RDT30CB	\$	726.00
1RDT30XB	\$	558.00
1RDT36CB	\$	780.00
1RDT36XB	\$	642.00
1RDT42CB	\$	858.00
1RDT42XB	\$	714.00
1RDT48CB	\$	954.00
1RDT48XB	\$	756.00
1R3672PB	\$	1,035.00
1R3684PB	\$	1,065.00
1R4296PB	\$	1,125.00
1R4896PB	\$	1,185.00
w/ "RC"- radius corners	\$	117.00

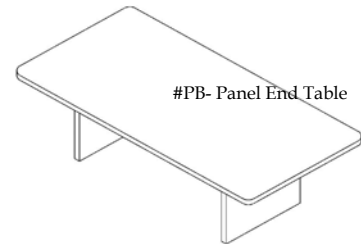
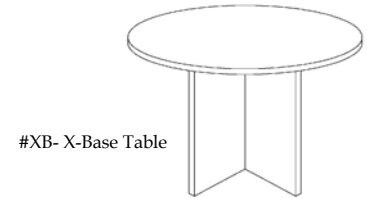
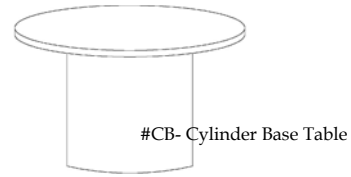

MISCELLANEOUS ITEMS

LIST PRICE

Printer Stand

1PS2424	\$	405.00
---------	----	--------

Cabinets- Hinged Door

1HD01 30Wx24Dx30H	\$	642.00
1HD02 36Wx24Dx30H	\$	681.00
1HD03 30Wx24Dx36H	\$	747.00
1HD04 36Wx24Dx36H	\$	801.00
w/ "L"- Lock	\$	51.00

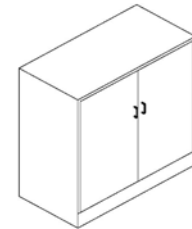

Parsons Table: Up to 23" High

PT01 18x24	\$	360.00
PT02 18x36	\$	384.00
PT03 18x48	\$	411.00

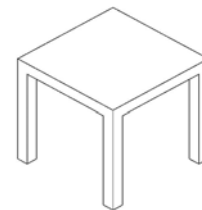

Cube Tables w/ Radius Corners

CT01 18x18	\$	504.00
CT02 20x20	\$	546.00
CT03 24x24	\$	591.00
w/ "R"- Recessed Base	\$	96.00

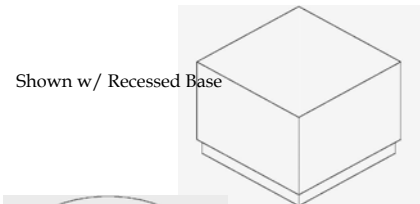

Drum Tables: Up to 23" High

DT01 18" Diameter	\$	492.00
DT02 24" Diameter	\$	531.00

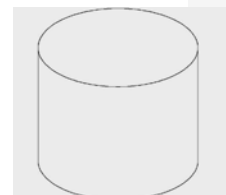

CREST MANUFACTURING CORPORATION

MODULAR FURNITURE

LIST PRICE

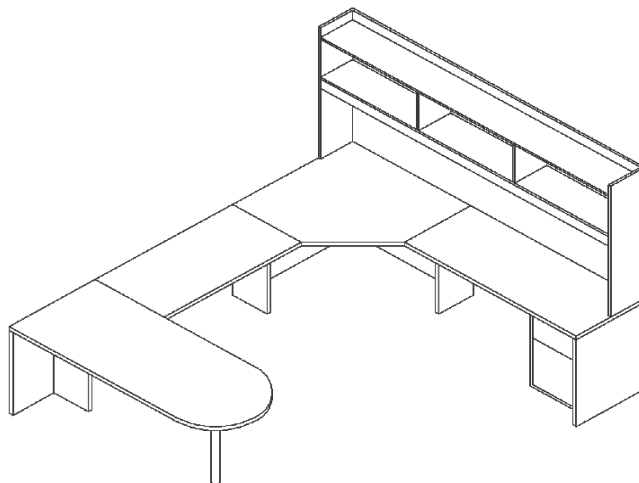

Bullet Workstation

1B3060	\$	651.00
1B3066	\$	678.00
1B3072	\$	711.00
1B3660	\$	795.00
1B3666	\$	825.00
1B3672	\$	855.00
Post Leg for 30" Deep Bullet	\$	87.00
T-Leg for 36" Deep Bullet	\$	120.00

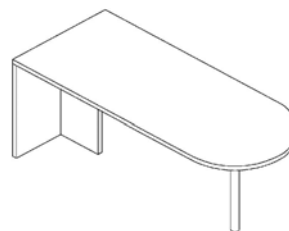

5-Sided Corner Unit

1COR2436	\$	744.00
1COR2442	\$	801.00
1COR3048	\$	858.00

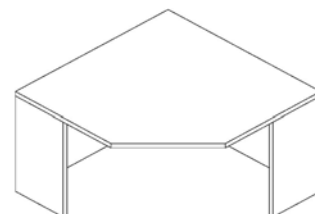

Bridge Connectors w/Modesty Panels & Brackets

1BR2436	\$	270.00
1BR2442	\$	294.00
1BR2448	\$	318.00
1BR2460	\$	483.00

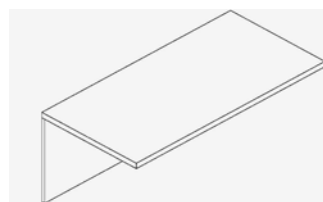

Return Shell

1RET2436	\$	345.00
1RET2442	\$	363.00
1RET2448	\$	381.00
1RET2460 (w/ 1/2 leg)	\$	459.00
1RET2466 (w/ 1/2 leg)	\$	483.00
1RET2472 (w/ 1/2 leg)	\$	498.00

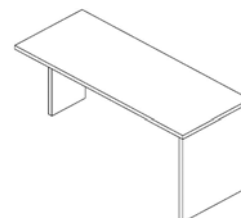

CREST MANUFACTURING CORPORATION

Pedestals

1PD01 BF (21" Deep) Suspended	\$ 300.00
1PD02 BBB (21" Deep) Suspended	\$ 300.00
1PD05 BBBB (21" Deep) Floor w/ top	\$ 486.00
1PD06 BBF (21" Deep) Floor w/ top	\$ 486.00
1PD07 FF (21" Deep) Floor w/ top	\$ 486.00
1PD09 BBF (24" Deep) Floor w/ top	\$ 519.00
1PD10 FF (24" Deep) Floor w/ top	\$ 519.00
w/ "C"-Casters	\$ 111.00
w/ "L"- Lock	\$ 53.00

Counter Approach Risers

1C121248	\$ 288.00
1C121260	\$ 330.00
1C121266	\$ 345.00
1C121272	\$ 345.00
1C121278 (incl. center support)	\$ 405.00
1C121284 (incl. center support)	\$ 459.00
1C1212102 (incl. center support)	\$ 579.00

TOPS

LIST PRICE

Lateral File Tops: 17 3/4" Deep

LFT30	\$ 102.00
LFT36	\$ 117.00
LFT42	\$ 135.00
LFT60	\$ 192.00
LFT72	\$ 225.00
LFT108 (w/seam)	\$ 372.00
LFT108 (w/ no seam)	\$ 516.00

Round

T36R	\$ 225.00
T42R	\$ 249.00
T48R	\$ 276.00
T60R	\$ 492.00

Square

SQ3030	\$ 186.00
SQ3636	\$ 225.00
SQ4242	\$ 249.00
SQ4848	\$ 255.00

CREST MANUFACTURING CORPORATION

Rectangle

T1830	\$	93.00
T1836	\$	117.00
T1842	\$	120.00
T1872	\$	225.00
T18108	\$	378.00
T2436	\$	132.00
T2448	\$	171.00
T2460	\$	213.00
T2472	\$	255.00
T3060	\$	252.00
T3072	\$	297.00
T3660	\$	288.00
T3672	\$	345.00
T3684	\$	405.00
T3696	\$	498.00
T36108 (w/ seam)	\$	630.00
T36108 (w/ no seam)	\$	708.00
Built Up Self Edge	\$	228.00

Racetrack

RT3672	\$	459.00
RT3684	\$	534.00
RT3696	\$	609.00
RT36108	\$	762.00
RT4272	\$	534.00
RT4284	\$	684.00
RT4296	\$	684.00
RT42108	\$	837.00
RT4872	\$	609.00
RT4884	\$	684.00
RT4896	\$	762.00
RT48108	\$	912.00

6000 SERIES- VISIONS

LIST PRICE

MODULAR TEACHER PACKAGE

#6V2472- Kidney Shaped Desk	\$	882.00
#6V3084DB- Double P-Shaped Desk	\$	1,014.00
#6V2472- Credenza (Open Storage)	\$	936.00
#6VPED- B/B/F Mobile Pedestal	\$	477.00
#6VBC29- Mobile Bookcase	\$	375.00
#6V3066SC- Combo Storage/Filing	\$	1,161.00



CREST MANUFACTURING CORPORATION

1000 SERIES TABLE BASES

LIST PRICE

TABLE BASES, STEEL

Standard paint finish is **Black**; other finishes available at an upcharge

Pedestal:

#XL-30 (26" spread)	\$	201.00
#XL-36 (32" spread)	\$	216.00
#XL-42 (36" spread)	\$	231.00
#XL-48 (42" spread)	\$	249.00
#4XL-38 (38" spread, 4 column)	\$	306.00

Single Column:

#TL-18 (16" spread)	\$	102.00
#TL-22 (20" spread)	\$	111.00
#TL-24 (22" spread)	\$	114.00
#TL-30 (26" spread)	\$	117.00

Dual Column:

#2TL-24 (22" spread)	\$	147.00
#2TL-30 (26" spread)	\$	156.00
#2TL-42 (36" spread)	\$	168.00

H-Legs:

#HL-24 (16.5" spread)	\$	123.00
#HL-30 (22.5" spread)	\$	129.00
#HL-342 (30" spread)	\$	177.00

P-Legs

#PL-27-2 (2" column)	\$	60.00
#PL-27 (2 3/8" column)	\$	84.00
#PL-27-4 (4" column)	\$	108.00
#RL (2" column)	\$	90.00

Round Bases w/Plate:

#C4-22PLP (22" floor plate)	\$	234.00
#C4-26PLP (26" floor plate)	\$	249.00

TABLE BASES, LAMINATE

1 1/8" thick "H" panel style with center support

#1PBH72 (for 72" wide top)	\$	450.00
#1PBH84 (for 84" wide top)	\$	519.00
#1PBH96 (for 96" wide top)	\$	591.00
#1PBH108 (for 108" wide top)	\$	732.00
#1PBH120 (for 120"L top -- 3 panels)	\$	834.00

CREST MANUFACTURING CORPORATION

<u>OTHER ACCESSORIES</u>	<u>LIST PRICE</u>
Basic Power Strip (6')	\$ 35.00
Upgraded Power Strip (20')	\$ 54.00
Cornersleeve Corner Adapter	\$ 120.00
Deluxe Keyboard Tray w/ Mouse Pad	\$ 300.00
J-Wire Manager (cost per linear foot)	\$ 8.20
Articulating Keyboard/Mouse Tray	\$ 195.00
Mouse Tray for Standard KB Tray	\$ 75.00
Basic Task Light (18")	\$ 58.00
Upgraded Task Light (24")	\$ 120.00
Upgraded Task Light (48")	\$ 150.00
w/ Center Drawer	\$ 78.00
w/ Lock for 3/4 Pedestal	\$ 53.00
w/Lock for Full Pedestal	\$ 58.00
Wire Grommet	\$ 30.00
Supply Tray (for box drawer)	\$ 12.00

<i>Standard Top</i>	<i>Standard Base</i>	<i>Standard PVC Edges</i>
<i>Laminates</i>	<i>Laminates</i>	<i>Standard PVC Edges</i>
African Walnut	African Walnut	African Walnut
Beige Grafix	Birchtone	Birchtone
Birchtone	Black	Black
Black	Brushed Aluminum	Brushed Aluminum
Cherry	Cherry	Cherry
Cherry Birch	Cherry Birch	Cherry Birch
Cognac	Cognac	Cognac
Crayon	Folkstone	Folkstone
EV Silcon	Fruitwood	Fruitwood
Folkstone	Maple	Maple
Folkstone Grafix	Natural Oak	Natural Oak
Fruitwood	Storm	Storm
Grey Canvas		
Maple		
Natural Canvas		
Natural Oak		
Storm		

CREST MANUFACTURING CORPORATION

GENERAL SPECIFICATIONS FOR STEEL PRODUCT

WARRANTY- Construction specification meet or exceed all ANSI-BIFMA specifications for durability and safety. All steel product is backed by a **LIFETIME WARRANTY** to ensure long-lasting performance.

A. Lateral File Construction Features

- (1) All welded steel frame construction, formed in key areas for strength.
- (2) 18 gauge inner frame, 20-22 gauge outer panels, cold rolled steel
- (3) Reinforced vertical and horizontal channels for dimensional stability.
- (4) All file drawers include all steel ball-bearing full extension slides with built in "anti-rebound" features to ensure smooth operation.
- (5) Safety interlock mechanism allows for only one drawer to be opened at a time.
- (6) Counterweights- factory installed and standard on all two, three, and four drawer lateral files.
- (7) Front to back bars are standard for all lateral files. Front-to-back bars must be ordered separately for combination file/storage units.
- (8) Product finish- epoxy-polyester powder, electrostatically applied paint.

B. Pedestal Construction Features

- (1) All welded steel frame construction, formed in key areas for strength.
- (2) Inner top and side pannel consist of 18-21 guage, cold rolled steel
- (3) Outer wrapper and drawer bins are 22 gauge, double walled 20 gauge drawers fronts on all box and file drawers. Lateral file drawer on file center only- doubled walled drawer front.
- (4) Reinforced vertical and horizontal channels for dimensional stability.
- (5) All file drawers include all steel ball-bearing full extension slides with built in "anti-rebound" features to ensure smooth operation. Box drawers upgraded full extension slides.
- (6) Product finish- epoxy-polyester powder, electrostatically applied paint.

C. Other Construction Features

- (1) UM Series locks (Series #226-426), black-faced, master-keyed, core removable.
- (2) Unless otherwise specified, all combination storage/file units feature central locking.
- (3) Full extension steel ball-bearing slides standard on all units.
- (4) Safety Interlock Feature- one drawer operation- standard on all units.
- (5) Double walled construction for all bookcases- bookshelf load capacities: 30"- 70 lbs, 36"- 85 lbs, 42" 100 lbs.
- (6) Storage cabinets with 18 gauge top and side channels with 20-22 gauge side/back panels & doors. Shelf load capacities: 30"- 90 lbs, 36"- 105 lbs, 42"- 125 lbs.

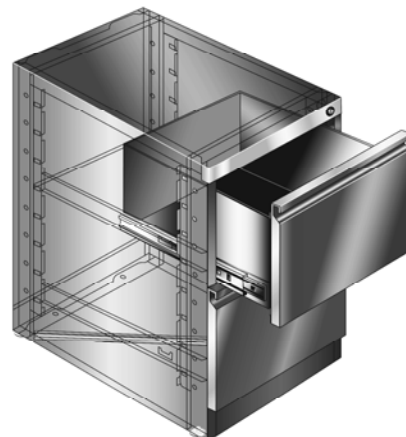
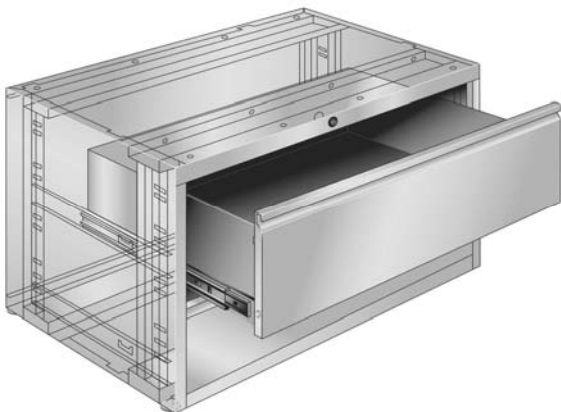

CREST MANUFACTURING CORPORATION

METAL FILING & STORAGE

LIST PRICE

2 Drawer File

#CRRN-A-0101-???-W (2 Dr.- 30"W)	\$	771.00
#CRRN-A-0201-???-W (2 Dr.- 36"W)	\$	838.00
#CRRN-A-0301-???-W (2 Dr.- 42"W)	\$	901.00

** Counterweights & Package of (4) Conversion Bars- Included



3 Drawer Lateral Files

#CRRN-A-0402-???-W (3 Dr.- 30"W)	\$	935.00
#CRRN-A-0502-???-W (3 Dr.- 36"W)	\$	1,018.00
#CRRN-A-0602-???-W (3 Dr.- 42"W)	\$	1,099.00

** Counterweights & Package of (6) Conversion Bars- Included



4 Drawer Lateral Files

#CRRN-A-0703-???-W (4 Dr.- 30"W)	\$	1,089.00
#CRRN-A-0803-???-W (4 Dr.- 36"W)	\$	1,190.00
#CRRN-A-0903-???-W (4 Dr.- 42"W)	\$	1,288.00

** Counterweights & Package of (8) Conversion Bars- Included



5 Drawer Lateral Files

#CR-RN-A-1004-???-W (5 Dr.- 30"W)	\$	1,328.00
#CRRN-A-1104-???-W (5 Dr.- 36"W)	\$	1,466.00
#CRRN-A-1204-???-W (5 Dr.- 42"W)	\$	1,604.00

** Package of (12) Conversion Bars- Included

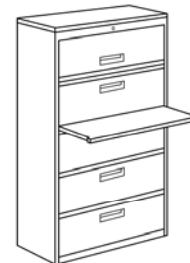

5 Drawer Lateral Files- Posting Shelf

#CRRN-A-1092-???-W (5 Dr.- 30"W)	\$	1,302.00
#CRRN-A-1192-???-W (5 Dr.- 36"W)	\$	1,430.00
#CRRN-A-1292-???-W (5 Dr.- 42"W)	\$	1,572.00

** Package of (12) Conversion Bars- Included

Worksurface Supporting File Center

#CRWN-A-0101-???-U (30"/30")	\$	584.00
#CRWN-A-0102-???-U (12"/12"/30")	\$	754.00
#CRWN-A-0103-???-FU (6"/6"/12"/30")	\$	811.00
#CRWN-A-0201-??? (36"/36")	\$	640.00

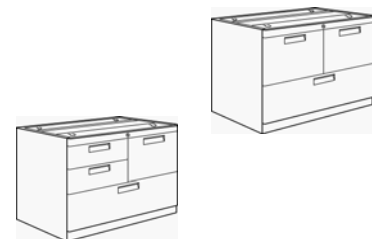

6"/6"/12"/30"

Freestanding File Center- Metal Top

#CRWN-A-0102-???-TU (12"/12"/30")	\$	965.00
#CRWN-A-0103-???-TFU (6"/6"/12"/30")	\$	1,046.00

File Accessories

#CRLME-4500-19 (4 ea.) Conversion Bars	\$	15.00
#CRLFM-300-30 (3 ea.) Magnetic Divider	\$	43.00
#CRTGOX-000-11 (10 ea.) Magnetic Labels	\$	14.00

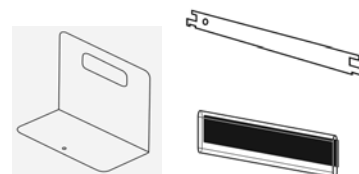

CREST MANUFACTURING CORPORATION

Lateral File/Storage Cabinet

#CRRN-A-5190-??? (2 Dr.-30"W x 64 1/8"H)	\$	1,350.00
#CRRN-A-5290-??? (2 Dr.-36"W x 64 1/8"H)	\$	1,501.00
#CRRN-A-5390-??? (2 Dr.-42"W x 64 1/8"H)	\$	1,654.00
#CRRN-A-4889-??? (3 Dr.-30"W x 64 1/8"H)	\$	1,391.00
#CRRN-A-4989-??? (3 Dr.-36"W x 64 1/8"H)	\$	1,545.00
#CRRN-A-5089-??? (3 Dr.-42"W x 64 1/8"H)	\$	1,721.00
#CRRN-A-5797-??? (3 Dr.-30"W x 76 1/4"H)	\$	1,610.00
#CRRN-A-5897-??? (3 Dr.-36"W x 76 1/4"H)	\$	1,790.00
#CRRN-A-5997-??? (3 Dr.-42"W x 76 1/4"H)	\$	1,992.00
#CRRN-A-5498-??? (4 Dr.-30"W x 76 1/4"H)	\$	1,651.00
#CRRN-A-5598-??? (4 Dr.-36"W x 76 1/4"H)	\$	1,835.00
#CRRN-A-5698-??? (4 Dr.-42"W x 76 1/4"H)	\$	2,043.00

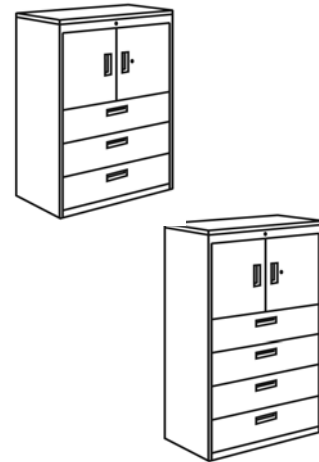

Overfile Units

#CRRNR-0132-??? (Radiused 30"W)	\$	643.00
#CRRNR-0232-??? (Radiused 36"W)	\$	661.00
#CRRNR-0332-??? (Radiused 42"W)	\$	681.00
#CRRNS-0132-??? (Square 30"W)	\$	643.00
#CRRNS-0232-??? (Square 36"W)	\$	661.00
#CRRNS-0332-??? (Square 42"W)	\$	681.00

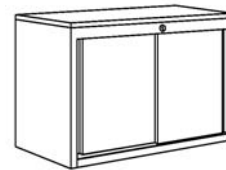

Worksurface Supporting Pedestals

#CREN-A-2909-???-U (F/F- 17 7/8"D x 27 3/4"H)	\$	394.00
#CREN-A-2911-???-FU (B/B/F- 17 7/8"D x 27 3/4"H)	\$	451.00
#CREN-A-3009-???-U (F/F- 21 7/8"D x 27 3/4"H)	\$	398.00
#CREN-A-3011-???-FU (B/B/F- 21 7/8"D x 27 3/4"H)	\$	459.00
#CREN-A-3109-???-U (F/F- 27 7/8"D x 27 3/4"H)	\$	451.00
#CREN-A-3111-???-FU (B/B/F- 27 7/8"D x 27 3/4"H)	\$	496.00

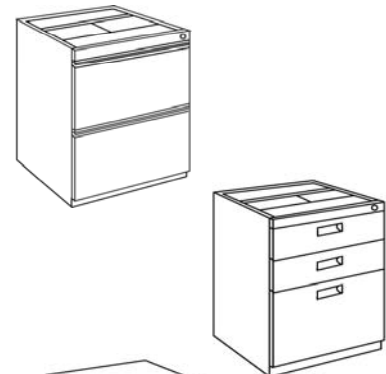

Mobile Pedestals

#CREN-A-2009-???-U (F/F- 18 7/8"D x 27 1/8"H)	\$	432.00
#CREN-A-2011-???-FU (B/B/F- 18 7/8"D x 27 1/8"H)	\$	500.00
#CREN-A-2109-???-U (F/F- 21 7/8"D x 27 1/8"H)	\$	438.00
#CREN-A-2111-???-FU (B/B/F- 21 7/8"D x 27 1/8"H)	\$	505.00
#CREN-A-2209-???-U (F/F- 27 7/8"D x 27 1/8"H)	\$	487.00
#CREN-A-2211-???-FU (B/B/F- 27 7/8"D x 27 1/8"H)	\$	537.00
#CREN-A-1403-???-FU (B/F- 18 7/8"D x 21 3/8"H)	\$	406.00
#CREN-A-1503-???-FU (B/F- 21 7/8"D x 21 3/8"H)	\$	415.00
#CREN-A-1603-???-FU (B/F- 27 7/8"D x 21 3/8"H)	\$	449.00

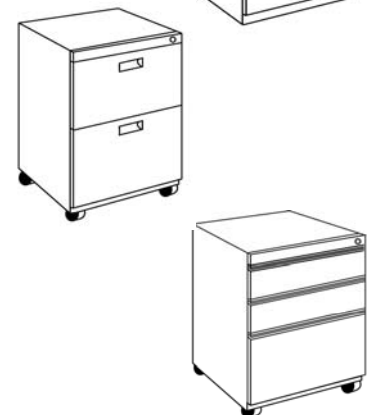

CREST MANUFACTURING CORPORATION

Freestanding Pedestals

#CREN-A-6109-???-U (F/F- 18 7/8"D x 27 3/4"H)	\$	402.00
#CREN-A-6111-???-FU (B/B/F- 18 7/8"D x 27 3/4"H)	\$	461.00
#CREN-A-5109-???-U (F/F- 21 7/8"D x 27 3/4"H)	\$	413.00
#CREN-A-5111-???-FU (B/B/F- 21 7/8"D x 27 3/4"H)	\$	473.00
#CREN-A-5309-???-U (F/F- 27 7/8"D x 27 3/4"H)	\$	463.00
#CREN-A-5311-???-FU (B/B/F- 27 7/8"D x 27 3/4"H)	\$	526.00

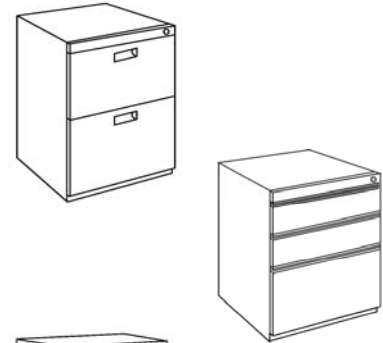

Wardrobe Storage Towers

#CRDN-A-1954-??? (L-Coat; R-F/F 37" Cupboard)	\$	1,459.00
#CRWN-A-1954-??? (R-Coat; L-F/F 37" Cupboard)	\$	1,459.00
#CRDN-A-1952-??? (L-Coat; R-F/F/F 25" Cupboard)	\$	1,509.00
#CRWN-A-1952-??? (R-Coat; L-F/F/F 25" Cupboard)	\$	1,509.00
#CRDN-A-8154-??? (L-Coat; R-F/F 37" Cup.- Mobile)	\$	1,543.00
#CRWN-A-8154-??? (R-Coat; L-F/F 37" Cup.- Mobile)	\$	1,543.00

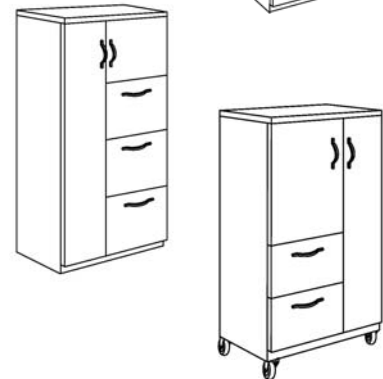

Double Door Storage Cabinet

#CRCN-A-0230-??? (27 3/4"H x 36"W- 1 Adj. Shelf)	\$	608.00
#CRCN-A-0530-??? (39 7/8"H x 36"W- 2 Adj. Shelves)	\$	828.00
#CRCN-A-0830-??? (52"H x 36"W- 3 Adj. Shelves)	\$	940.00
#CRCN-A-1130-??? (64 1/8"H x 36"W- 4 Adj. Shelves)	\$	1,074.00
#CRCN-A-1173-??? (64 1/8"H x 36"W- Coat Rod)	\$	895.00
#CRDMEX-0069-??? (Additional 36"W Shelf)	\$	45.00

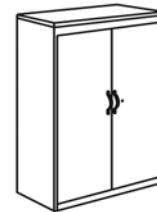

Metal Bookcases- Square Front

#CRBNS-3027-??? (28"H x 30"W- 1 Adj. Shelf)	\$	412.00
#CRBNS-3627-??? (28"H x 36"W- 1 Adj. Shelf)	\$	430.00
#CRBNS-4227-??? (28"H x 42"W- 1 Adj. Shelf)	\$	453.00
#CRBNS-3039-??? (41"H x 30"W- 2 Adj. Shelf)	\$	475.00
#CRBNS-3639-??? (41"H x 36"W- 2 Adj. Shelf)	\$	492.00
#CRBNS-4239-??? (41"H x 42"W- 2 Adj. Shelf)	\$	515.00
#CRBNS-3052-??? (52"H x 30"W- 3 Adj. Shelf)	\$	517.00
#CRBNS-3652-??? (52"H x 36"W- 3 Adj. Shelf)	\$	537.00
#CRBNS-4252-??? (52"H x 42"W- 3 Adj. Shelf)	\$	559.00
#CRBNS-3064-??? (66 3/8"H x 30"W- 4 Adj. Shelf)	\$	577.00
#CRBNS-3664-??? (66 3/8"H x 36"W- 4 Adj. Shelf)	\$	596.00
#CRBNS-4264-??? (66 3/8"H x 42"W- 4 Adj. Shelf)	\$	620.00
#CRBNS-3076-??? (79 3/8"H x 30"W- 5 Adj. Shelf)	\$	627.00
#CRBNS-3676-??? (79 3/8"H x 36"W- 5 Adj. Shelf)	\$	644.00
#CRBNS-4276-??? (79 3/8"H x 42"W- 5 Adj. Shelf)	\$	668.00

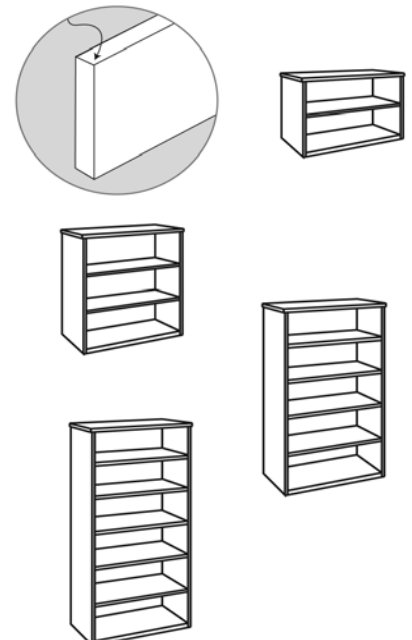

CREST MANUFACTURING CORPORATION

Metal Bookcases- Radiused Front

#CRBNR-3027-???	(28"H x 30"W- 1 Adj. Shelf)	\$	412.00
#CRBNR-3627-???	(28"H x 36"W- 1 Adj. Shelf)	\$	430.00
#CRBNR-4227-???	(28"H x 42"W- 1 Adj. Shelf)	\$	453.00
#CRBNR-3039-???	(41"H x 30"W- 2 Adj. Shelf)	\$	475.00
#CRBNR-3639-???	(41"H x 36"W- 2 Adj. Shelf)	\$	492.00
#CRBNR-4239-???	(41"H x 42"W- 2 Adj. Shelf)	\$	515.00
#CRBNR-3052-???	(52"H x 30"W- 3 Adj. Shelf)	\$	517.00
#CRBNR-3652-???	(52"H x 36"W- 3 Adj. Shelf)	\$	537.00
#CRBNR-4252-???	(52"H x 42"W- 3 Adj. Shelf)	\$	559.00
#CRBNR-3064-???	(66 3/8"H x 30"W- 4 Adj. Shelf)	\$	577.00
#CRBNR-3664-???	(66 3/8"H x 36"W- 4 Adj. Shelf)	\$	596.00
#CRBNR-4264-???	(66 3/8"H x 42"W- 4 Adj. Shelf)	\$	620.00
#CRBNR-3076-???	(79 3/8"H x 30"W- 5 Adj. Shelf)	\$	592.00
#CRBNR-3676-???	(79 3/8"H x 36"W- 5 Adj. Shelf)	\$	608.00
#CRBNR-4276-???	(79 3/8"H x 42"W- 5 Adj. Shelf)	\$	630.00

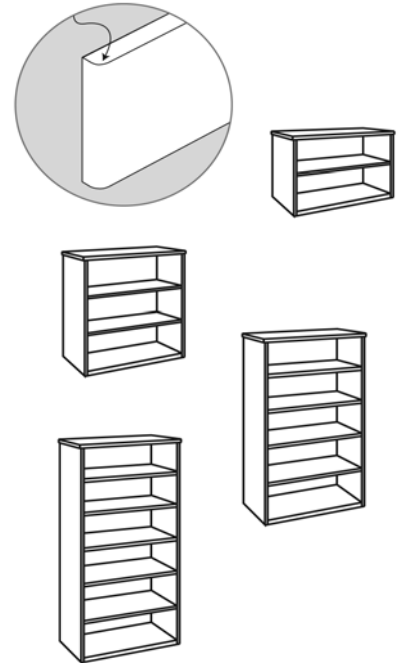

Extra Bookshelf- Either Series

#CRBK-0700-???	(Extra 30"W Bookshelf)	\$	39.00
#CRBK-0800-???	(Extra 36"W Bookshelf)	\$	39.00
#CRBK-0900-???	(Extra 42"W Bookshelf)	\$	39.00

<i>Color Number</i>	<i>Standard Paint Finishes</i>	<i>Color Number</i>	<i>Standard Paint Finishes</i>
529	Aegean	941	Midnight Green
232	AS Driftwood	729	Ming Gold
152	AS Tan	846	Ocean
942	Light Blue	943	Sage
675	Crimson	044	SC Black
348	HM Innertone Light	459	SC Cream
385	HM Just Tan	073	SC Gray Value 1
257	HM Light Gray	282	SC Mist
509	HM Slate Gray	095	SC Tan Value 1
179	HW Smoke	202	SC Warm Brown 1
661	KN Light Grey	304	SC Warm Brown 2